

Aluminum Electrolytic Capacitors Surface Mount AEC-Q200

SREM-A series

MERITEK

FEATURE

- Low Impedance Series
- Applications: Monitor/Computer, Battery Charger, DC/DC Converter, SMPS, Noise Filter
- AEC-Q200 Compliant
- Load life at 105°C



Diameter (mm)	Load Life (Hours)
4.0 ~ 6.3	1000
8.0 ~ 10.0	2000



SPECIFICATIONS

Item	Characteristic							
Operating Temperature	-55 ~ 105°C							
Rated Working Voltage	6.3 ~ 50VDC							
Nominal Capacitance	1 ~ 1500µF, ±20% (at 20°C, 120HZ)							
Leakage Current	$I_L \leq 0.01CV$ or $3\mu A$ whichever is greater after 2 minutes at 20°C I_L : Leakage Current (µA) C: Nominal Capacitance (µF) V: Rated Voltage (V)							
Ripple Current Coefficient, Frequency	Frequency (Hz)	120	1K	10K	100K	--	--	
	Coefficient	0.70	0.80	0.90	1.00	--	--	
Low Temperature Stability, Impedance Ratio at 120Hz	Working Voltage (V)	6.3	10	16	25	35	50	
	Z-25°C / Z+20°C	2	2	2	2	2	2	
	Z-40°C / Z+20°C	4	4	3	3	3	3	
Load Life	Capacitance	6.3V	$\leq \pm 30\%$ of initial value				Apply Working Voltage for Rated Load Life / Temperature Stabilized at +20°C.	
		10~50V	$\leq \pm 20\%$ of initial value					
	Dissipation Factor	$\leq 200\%$ of initial value						
	Leakage Current	\leq Initial specified value						
Shelf Life	Capacitance	$\leq \pm 25\%$ of initial value				After storage condition without voltage applied for 1000 hours at Rated Temperature, Stabilizing for 1 to 2 hours.		
	Dissipation Factor	$\leq 200\%$ of initial value						
	Leakage Current	\leq Initial specified value						
Resistance to Soldering Heat	Capacitance	$\leq \pm 20\%$ of initial value				For other procedures than those specified, Soldering iron method: Temperature: 260±5°C. Application time of soldering iron: 10 sec		
	Dissipation Factor	\leq specified value						
	Leakage Current	\leq specified value						

Aluminum Electrolytic Capacitors Surface Mount AEC-Q200

SREM-A series

MERITEK

STANDARD RATING

Rated Voltage	Rated Cap	Case Size	DF Tan δ	Ripple Current	Max Impedance
(V _{DC})	(μ F)	(mm)	(%)	(mA/rms)	(Ω)
6.3	22	4x5.4	0.26	60	3.00
	33	5x5.4	0.26	95	1.80
	47	5x5.4	0.26	95	1.80
	100	6.3x5.4	0.26	140	1.00
	220	6.3x5.4	0.26	140	1.00
	330	6.3x7.7	0.26	280	0.34
	470	8x10.2	0.35	450	0.30
	680	8x10.2	0.35	450	0.30
	1000	8x10.2	0.35	450	0.30
	1500	10x10.2	0.35	670	0.15
10	22	5x5.4	0.22	95	1.80
	33	5x5.4	0.22	95	1.80
	47	6.3x5.4	0.22	140	1.00
	100	6.3x5.4	0.22	140	1.00
	220	6.3x7.7	0.22	280	0.34
	330	8x10.2	0.26	450	0.30
	470	8x10.2	0.26	450	0.30
	680	10x10.2	0.26	670	0.15
	1000	10x10.2	0.26	670	0.15
	16	10	4x5.4	0.16	60
22		5x5.4	0.16	95	1.80
33		6.3x5.4	0.16	140	1.00
47		6.3x5.4	0.16	140	1.00
100		6.3x5.4	0.16	140	1.00
220		6.3x7.7	0.16	280	0.34
330		8x10.2	0.20	450	0.30
470		8x10.2	0.20	450	0.30
680		10x10.2	0.20	670	0.15

Note: Ripple Current measured at 105°C/100KHz, Impedance at 20°C/100KHz

Rated Voltage	Rated Cap	Case Size	DF Tan δ	Ripple Current	Max Impedance
(V _{DC})	(μ F)	(mm)	(%)	(mA/rms)	(Ω)
25	10	5x5.4	0.14	95	1.80
	22	6.3x5.4	0.14	140	1.00
	33	6.3x5.4	0.14	140	1.00
	47	6.3x5.4	0.14	140	1.00
	68	6.3x7.7	0.14	280	0.34
	100	6.3x7.7	0.14	280	0.34
	220	8x10.2	0.16	450	0.30
	330	8x10.2	0.16	450	0.30
	470	10x0.2	0.16	670	0.15
	35	4.7	4x5.4	0.12	60
10		5x5.4	0.12	95	1.80
22		6.3x5.4	0.12	140	1.00
33		6.3x5.4	0.12	140	1.00
47		6.3x5.4	0.12	140	1.00
68		6.3x7.7	0.12	280	0.34
100		8x10.2	0.14	450	0.30
220		8x10.2	0.14	450	0.30
330		10x10.2	0.14	670	0.15
50		1.0	4x5.4	0.12	30
	2.2	4x5.4	0.12	30	5.00
	3.3	4x5.4	0.12	30	5.00
	4.7	5x5.4	0.12	50	3.00
	10	6.3x5.4	0.12	70	2.00
	22	6.3x5.4	0.12	70	2.00
	33	6.3x7.7	0.12	170	1.30
	47	6.3x7.7	0.12	170	1.30
	68	8x10.2	0.12	300	0.60
	100	8x10.2	0.12	300	0.60
	220	10x10.2	0.12	500	0.30

Aluminum Electrolytic Capacitors Surface Mount AEC-Q200

SREM-A series

MERITEK

DIMENSION

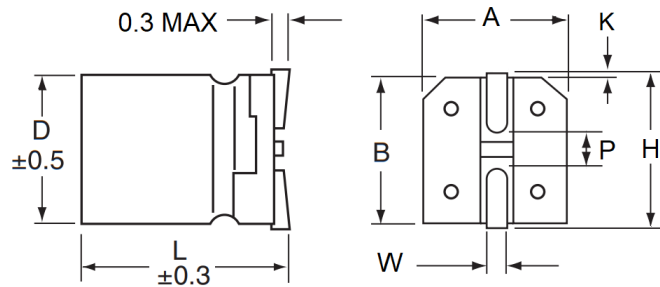

Unit: mm

D	L	A ±0.2	B ±0.2	H Max	W	P ±0.2	K
4.0 (D)	5.4	4.3	5.0	5.5	0.65±0.1	1.0	0.35+0.15/-0.2
5.0 (E)	5.4	5.3	6.0	6.5	0.65±0.1	1.5	0.35+0.15/-0.2
6.3 (F)	5.4	6.6	7.3	7.8	0.65±0.1	2.1	0.35+0.15/-0.2
6.3 (F)	7.7	6.6	7.3	7.8	0.65±0.1	2.1	0.35+0.15/-0.2
8.0 (H)	10.2	8.3	9.1	10.0	0.90±0.2	3.1	0.70±0.20
10.0 (J)	10.2	10.3	11.1	12.0	0.90±0.2	4.6	0.70±0.20

PART NUMBERING SYSTEM

SREM (1) **1H** (2) **221** (3) **A** (4) **J102** (5)

No	Item	Code	Description
(1)	Product Code	SREM	Aluminum Electrolytic Capacitors, SMD type, 1000, 2000 Hrs 105°C
(2)	Rated Voltage	1H	50VDC DC Voltage Code
(3)	Capacitance	221	220µF ±20% (M) First two digits: significant, Third: Multiplier
(4)	Series Code	A	AEC-Q200 Compliant Series
(5)	Size Code	J102	10x10.2mm DxL (mm)

Voltage	4	6.3	10	16	25	35	50	63	100	160	200	250	350	400	450	500
Code	0G	0J	1A	1C	1E	1V	1H	1J	2A	2C	2D	2E	2V	2G	2W	2H

Diameter	4	5	6.3	8	10	12.5	14.5	16	18	20	22	25
Code	D	E	F	H	J	K	U	L	M	N	P	Q

*Specifications subject to change without notice.