

Aluminum Electrolytic Capacitors Surface Mount AEC-Q200

SET-A series

MERITEK

FEATURE

- High Temperature Series
- AEC-Q200 Compliant
- Applications : Automatic Mounting and Reflow Soldering, Industrial, Automobile, Meter
- Load life at 125°C



Diameter (mm)	Load Life (Hours)
6.3x7.7 ~ 8.0x6.2	1000
8.0x10.2 ~ 10.0x10.2	2000

SPECIFICATIONS

Item	Characteristic					
Operating Temperature	-40 ~ 125°C					
Rated Working Voltage	10 ~ 50VDC					
Nominal Capacitance	47 ~ 1000μF, ±20% (at 20°C, 120HZ)					
Leakage Current	$I_L \leq 0.01CV$ or $3\mu A$ whichever is greater after 2 minutes at 20°C					
Ripple Current Coefficient, Frequency	Frequency (Hz)	60	120	1K	10K	--
	Coefficient	0.85	1.00	1.20	1.30	--
Dissipation Factor at 20°C, 120Hz	Working Voltage(V)	10	16	25	35	50
	Dissipation Factor	0.26	0.20	0.18	0.14	0.12
Low Temperature Stability, Impedance Ratio at 120Hz	Working Voltage(V)	10	16	25	35	50
	Z-25°C / Z+20°C	2	2	2	2	2
	Z-40°C / Z+20°C	3	3	3	3	3
Load Life	Capacitance	$\leq \pm 30\%$ of initial value				Apply Working Voltage for Rated Load Life / Temperature Stabilized at +20°C.
	Dissipation Factor	$\leq 300\%$ of initial value				
	Leakage Current	\leq Initial specified value				
Shelf Life	Capacitance	$\leq \pm 20\%$ of initial value				After storage condition without voltage applied for 1000 hours at Rated Temperature, Stabilizing for 1 to 2 hours.
	Dissipation Factor	$\leq 200\%$ of initial value				
	Leakage Current	$\leq 200\%$ of initial value				
Resistance to Soldering Heat	Capacitance	$\leq \pm 20\%$ of initial value				For other procedures than those specified, Soldering iron method: Temperature: 260±5°C. Application time of soldering iron: 10 sec
	Dissipation Factor	\leq specified value				
	Leakage Current	\leq specified value				

Aluminum Electrolytic Capacitors Surface Mount AEC-Q200

SET-A series

MERITEK

SPECIFICATIONS

Rated Voltage	Rated Capacitance		Tan δ	Case Size DxL	Ripple Current
	(V _{DC})	(μ F) Code			
10	100	101	0.26	8x6.2	75
	150	151	0.26	6.3x7.7	70
	150	151	0.26	8x6.2	75
	220	221	0.26	8x10.2	130
	330	331	0.26	8x10.2	130
	470	471	0.26	8x10.2	130
	470	471	0.26	10x10.2	180
	680	681	0.26	10x10.2	180
	1000	102	0.26	10x10.2	180
	16	47	470	0.20	6.3x7.7
100		101	0.20	6.3x7.7	70
100		101	0.20	8x6.2	75
150		151	0.20	8x10.2	130
220		221	0.20	8x10.2	130
330		331	0.20	8x10.2	180
470		471	0.20	10x10.2	180
25		47	470	0.18	6.3x7.7
	47	470	0.18	8x6.2	75
	100	101	0.18	6.3x7.7	70
	100	101	0.18	8x6.2	75
	100	101	0.18	8x10.2	130
	150	151	0.18	8x10.2	130
	220	221	0.18	8x10.2	130
	220	221	0.18	10x10.2	180
	330	331	0.18	10x10.2	180

Rated Voltage	Rated Capacitance		Tan δ	Case Size DxL	Ripple Current	
	(V _{DC})	(μ F) Code				(%)
35	10	100	0.14	8x6.2	40	
	10	100	0.14	8x10.2	50	
	22	220	0.14	6.3x7.7	70	
	33	330	0.14	6.3x7.7	70	
	33	330	0.14	8x6.2	75	
	47	470	0.14	6.3x7.7	70	
	47	470	0.14	8x6.2	75	
	47	470	0.14	8x10.2	130	
	100	101	0.14	8x6.2	75	
	100	101	0.14	8x10.2	130	
	100	101	0.14	10x10.2	180	
	120	121	0.14	8x10.2	130	
	150	151	0.14	10x10.2	180	
	220	221	0.14	8x10.2	130	
	220	221	0.14	10x10.2	180	
	50	10	100	0.12	8x6.2	70
		10	100	0.12	8x10.2	75
		22	220	0.12	6.3x7.7	70
22		220	0.12	8x6.2	75	
33		330	0.12	8x10.2	130	
47		470	0.12	8x10.2	130	
82		850	0.12	8x10.2	130	
100		101	0.12	10x10.2	180	
150		151	0.12	10x10.2	180	
220		221	0.12	10x10.2	180	

Note: Ripple Current measured at 120Hz, 125°C

DIMENSION

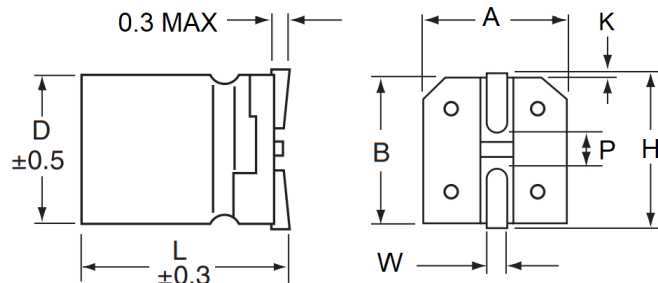

Unit: mm

D	L	A ± 0.2	B ± 0.2	H Max	W	P ± 0.2	K
6.3 (F)	7.7	6.6	7.3	7.8	0.65 \pm 0.1	2.1	0.35+0.15/-0.2
8.0 (H)	6.2	8.3	9.0	9.5	0.65 \pm 0.1	2.2	0.35+0.15/-0.2
8.0 (H)	10.2	8.3	9.1	10.0	0.90 \pm 0.2	3.1	0.70 \pm 0.20
10.0 (J)	10.2	10.3	11.1	12.0	0.90 \pm 0.2	4.6	0.70 \pm 0.20

Aluminum Electrolytic Capacitors Surface Mount AEC-Q200

SET-A series

MERITEK

PART NUMBERING SYSTEM

SET 1H 221 A J102
(1) (2) (3) (4) (5)

No	Item	Code	Description	
(1)	Product Code	SET	Aluminum Electrolytic Capacitors, SMD type, 1000 ~ 2000 Hrs 125°C	
(2)	Rated Voltage	1H	50VDC	DC Voltage Code, 1A to 1H
(3)	Capacitance	221	220µF ±20% (M)	First two digits: significant, Third: Multiplier
(4)	Series Code	A	AEC-Q200 Compliant Series	
(5)	Size Code	J102	10x10.2mm	DxL (mm)

Voltage	4	6.3	10	16	25	35	50	63	100	160	200	250	350	400	450	500
Code	0G	0J	1A	1C	1E	1V	1H	1J	2A	2C	2D	2E	2V	2G	2W	2H

Diameter	4	5	6.3	8	10	12.5	14.5	16	18	20	22	25
Code	D	E	F	H	J	K	U	L	M	N	P	Q

**Aluminum Electrolytic Capacitors
Surface Mount AEC-Q200**

SET-A series	MERITEK
--------------	----------------

*Specifications subject to change without notice.