

Zener Diodes Mini-MELF LL34

ZMM Series

MERITEK

FEATURE

- Zener Voltage Range: 2.0V to 75V
- Power Dissipation: 500mW
- Planar Die Construction
- Application: Power Management Systems, Voltage Regulation



MECHANICAL DATA

- Case: Mini-MELF, LL34, Hermetical Sealed Glass Molded
- Polarity: Cathode Indicated By Band



MAXIMUM RATINGS

Parameter	Symbols	Value	Unit
Power Dissipation	P_D	500	mW
Forward Voltage at $I_F=100\text{mA}$	V_F	1.0	V
Resistance Junction to Ambient ^(Note 1)	$R_{\theta JA}$	0.3	K/mW
Junction Temperature Range	T_J	-55~+175	°C
Storage Temperature Range	T_{STG}	-55~+175	°C

Note: $T_A = 25^\circ\text{C}$ unless otherwise noted

DIMENSIONS AND RECOMMENDED LAND PATTERN

Item	Min (mm)	Max (mm)
A	3.3	3.7
B	1.4	1.6
C	--	0.47
X	1.37	1.37
X2	2.34	2.34
X3	5.08	5.08
Y	1.62	1.62

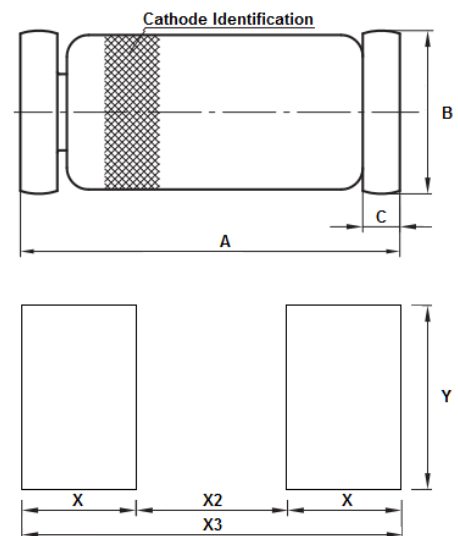

Zener Diodes Mini-MELF LL34

ZMM Series

MERITEK

ELECTRICAL CHARACTERISTICS

Part Number	Nominal Zener Voltage (Note 2)				Max Zener Impedance			Max Reverse Leakage Current	
	V _Z at I _{ZT}			I _{ZT}	Z _{ZT} at I _{ZT}	Z _{ZK} at I _{ZK}	I _{ZK}	I _R at V _R	
	Nom (V)	Min (V)	Max (V)	(mA)	(Ω)	(Ω)	(mA)	(μA)	(V)
ZMM2V0	2.0	1.80	2.15	5.0	85	600	1.0	100	1.0
ZMM2V2	2.2	2.08	2.33	5.0	85	600	1.0	75	1.0
ZMM2V4	2.4	2.28	2.56	5.0	85	600	1.0	50	1.0
ZMM2V7	2.7	2.50	2.90	5.0	85	600	1.0	10	1.0
ZMM3V0	3.0	2.80	3.20	5.0	85	600	1.0	4.0	1.0
ZMM3V3	3.3	3.10	3.50	5.0	85	600	1.0	2.0	1.0
ZMM3V6	3.6	3.40	3.80	5.0	85	600	1.0	2.0	1.0
ZMM3V9	3.9	3.70	4.10	5.0	85	600	1.0	2.0	1.0
ZMM4V3	4.3	4.00	4.60	5.0	75	600	1.0	1.0	1.0
ZMM4V7	4.7	4.40	5.00	5.0	60	600	1.0	0.5	1.0
ZMM5V1	5.1	4.80	5.40	5.0	35	550	1.0	0.1	1.0
ZMM5V6	5.6	5.20	6.00	5.0	25	450	1.0	0.1	1.0
ZMM6V2	6.2	5.80	6.60	5.0	10	200	1.0	0.1	2.0
ZMM6V8	6.8	6.40	7.20	5.0	8	150	1.0	0.1	3.0
ZMM7V5	7.5	7.00	7.90	5.0	7	50	1.0	0.1	5.0
ZMM8V2	8.2	7.70	8.70	5.0	7	50	1.0	0.1	6.2
ZMM9V1	9.1	8.50	9.60	5.0	10	50	1.0	0.1	6.8
ZMM10	10	9.4	10.6	5.0	15	70	1.0	0.1	7.5
ZMM11	11	10.4	11.6	5.0	20	70	1.0	0.1	8.2
ZMM12	12	11.4	12.7	5.0	20	90	1.0	0.1	9.1
ZMM13	13	12.4	14.1	5.0	26	110	1.0	0.1	10
ZMM15	15	13.8	15.6	5.0	30	110	1.0	0.1	11
ZMM16	16	15.3	17.1	5.0	40	170	1.0	0.1	12
ZMM18	18	16.8	19.1	5.0	50	170	1.0	0.1	13
ZMM20	20	18.8	21.2	5.0	55	220	1.0	0.1	15
ZMM22	22	20.8	23.3	5.0	55	220	1.0	0.1	16
ZMM24	24	22.8	25.6	5.0	80	220	1.0	0.1	18
ZMM27	27	25.1	28.9	5.0	80	220	1.0	0.1	20
ZMM30	30	28.0	32.0	5.0	80	220	1.0	0.1	22
ZMM33	33	31.0	35.0	5.0	80	220	1.0	0.1	24
ZMM36	36	34.0	38.0	5.0	80	220	1.0	0.1	27
ZMM39	39	37.0	41.0	2.5	90	500	0.5	0.1	30
ZMM43	43	40.0	46.0	2.5	90	500	0.5	0.1	33
ZMM47	47	44.0	50.0	2.5	110	600	0.5	0.1	36
ZMM51	51	48.0	54.0	2.5	125	700	0.5	0.1	39
ZMM56	56	52.0	60.0	2.5	135	700	0.5	0.1	43
ZMM62	62	58.0	66.0	2.5	150	1000	0.5	0.1	47
ZMM68	68	64.0	72.0	2.5	200	1000	0.5	0.1	51
ZMM75	75	70.0	79.0	2.5	250	1000	0.5	0.1	56

Note:

1. T_A = 25°C unless otherwise noted
2. Valid provided that electrodes are kept at ambient temperature
3. Tested with pulses tp=20ms.

CHARACTERISTIC CURVES

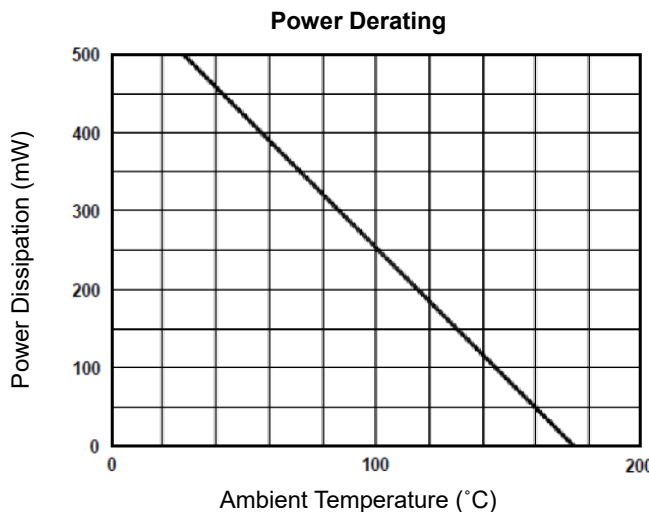
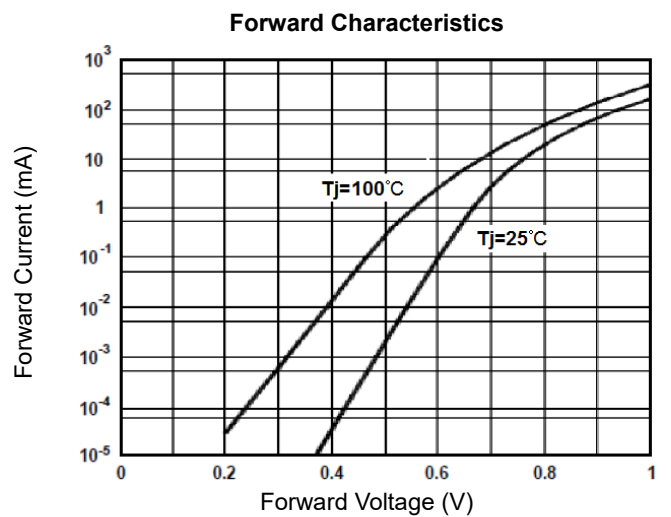
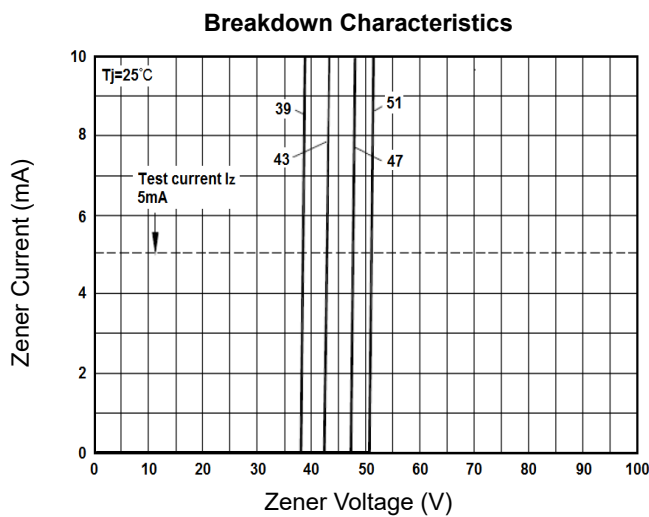
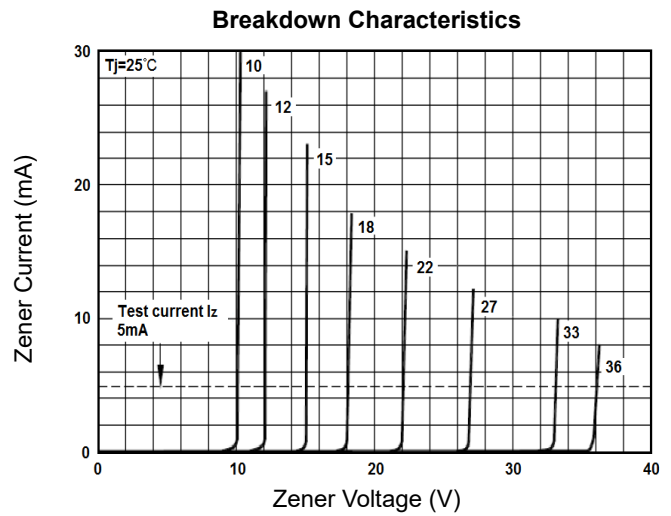
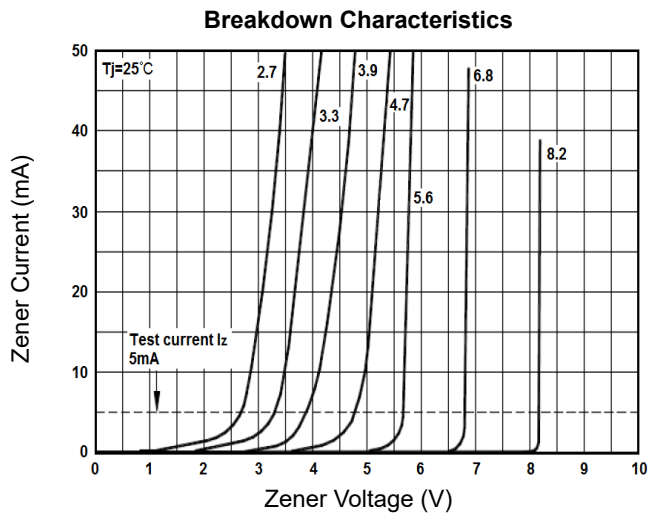

*Specifications subject to change without notice.