

Segmented Film Capacitors



RWSF Series

MERITEK

PART NUMBERING		RWSF	206	-	275	T2
Meritek Series						
*RWSF						
Capacitance						
CODE	101	102	103	104	105	106
(pF)	100PF	F	PF	0PF		
(nF)	---	1	10	100	F	
(μF)	---	0.001Uf	0.01	0.1	1	10
Dash						
Rated Voltage						
CODE	275					
	275V					
CODE	T2					
	Tab Terminal					

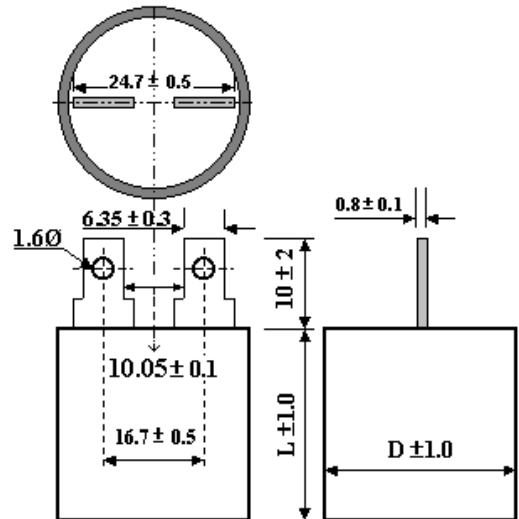

(μF)	(%)	(VAC)	Test Voltage (VDC)		Outline Dimensions/mm			
			T-T	T-C	D	L	LL	Mold
20	± 5	275	700	2000	35.5	61	100	1-64,FU
30	± 5	275	700	2000	45.5	77	100	1-57,FU
40	± 5	275	700	2000	45.5	77	100	1-57,FU

SPECIFICATIONS:

- UL FILE NO: E311150
- OPERATING TEMPERATURE: $-25^{\circ}\text{C} \sim +85^{\circ}\text{C}$.
- CAPACITANCE RANGE: 20.0, 30.0, 40.0 μF.
- CAPACITANCE TOLERANCE: $J = \pm 5\%$
- RATED WORKING VOLTAGE RANGE: 275 VAC 50/60 Hz.
- WITHSTAND VOLTAGE TEST:
 - Dielectric strength test
 - (TV): rated voltage x 175 % x 1.414 for VDC 1-5 Sec,
 - Between Terminals and Case
 - (TC): rated voltage x 2 + 1000V (minimum 2000 V) for one minute at 25°C .
- DISSIPATION FACTOR (DF): 0.5 % MAX. When measured at 1KHZ, 25°C .
- INSULATION RESISTANCE (IR):
 - Between Terminals: Above 5000 ΩF, at 100VDC in 25°C .
 - Between Terminals and Case: Above 10000MΩ, at 500VDC in 25°C .
- PERMISSIBLE OVERLOADS :
 - Voltage: At an r.m.s voltage between terminals not exceeding 110% the rated voltage.
 - Current: At an r.m.s current not exceeding 130% the current which occurs at rated sinusoidal voltage and rated frequency excluding transients. Taking into account the tolerance, the maximum permissible current can be up to 130% the rated current increased in proportion to the actual capacitance value compared with the rated capacitance value.
- LIFE TEST (Continued): Rated voltage X 135%, 1000hours, in the $+85^{\circ}\text{C}$ chamber.
 $\Delta C/C$ in $\pm 5\%$. $DF \leq 0.5\%$.
- Protected -P2 10,000 A. F. C. (Ampere Fault Current)
- Film: Segmented Metallized Film.